



ACADEMY
BELLA VISTA



ACADEMY
BELLA VISTA

tel: 303.938.1920
WWW.ACADEMYBOULDER.COM
BOULDER, COLORADO

PRICING SUBJECT TO CHANGE

©2023 | 2024 ACADEMY BOULDER
ALL RIGHTS RESERVED



FEE SCHEDULE & OPTIONS

MEMORY CARE
ASSISTED LIVING
HOMECARE

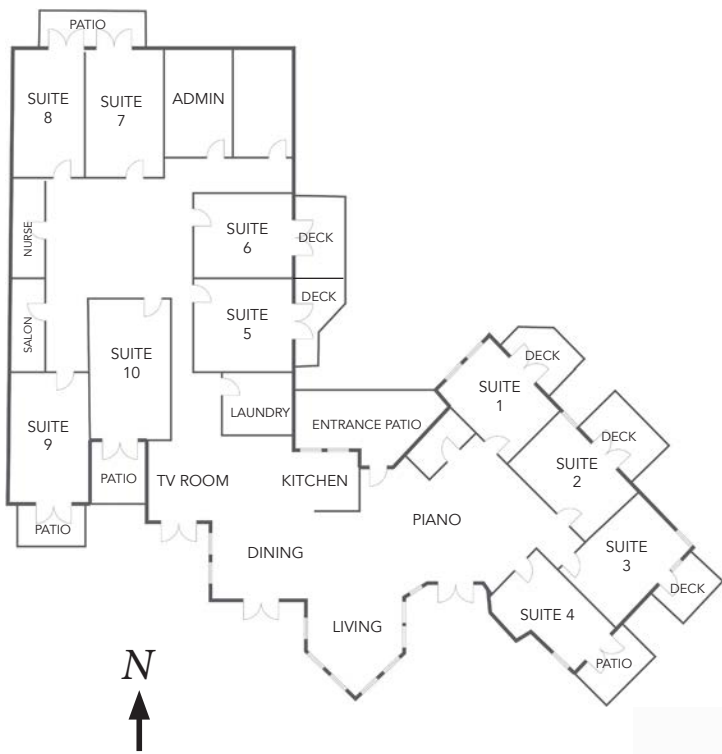

SEVENTEEN *years*
STRONG

2023
2006

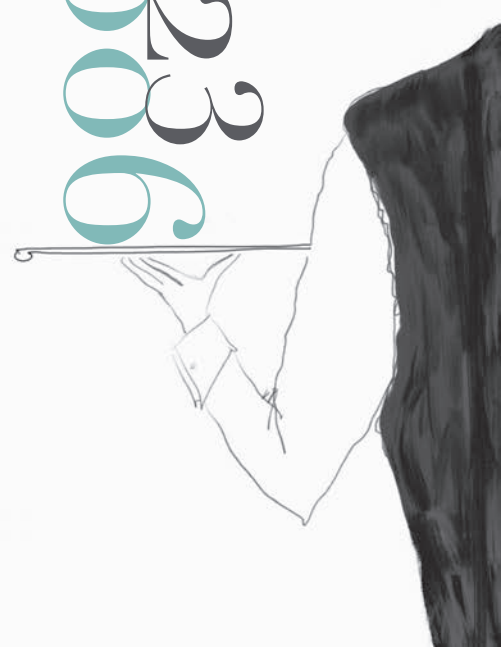

AWARDS

Excellence in Care
Dementia Program of Distinction
Alzheimer's Foundation of America

First Place
Daily Camera - Boulder County Gold
People's Choice Awards
Best Memory Care Facility

APPROACH

Academy Bella Vista is proud to follow the teachings of David Troxel and Virginia Bell - *The Best Friends Approach to Dementia Care*.

Alzheimer's disease changes us all. Because of the associated memory loss and confusion, your mother, father, sister, brother, husband, wife, or partner may no longer know you or understand his or her relationship to you. Many caregivers are confused, frustrated, sad, or even angry about these losses.

As a result, your relationship with the person changes whether you like it or not.

Adopting a Best Friends approach can help diminish this pain and loss and can have a powerful impact on the person with dementia. When you rethink, or recast, your relationships to individuals with dementia and become a Best Friend to them instead of just a caregiver, the person now feels you are on his or her side.

Recasting this relationship to become a Best Friend does not mean taking away love or loving the person with dementia any less. It simply means approaching the relationship differently.

~ David Troxel and Virginia Bell

I LONG
as does EVERY
HUMAN BEING
to be at HOME
WHEREVER
I FIND *myself*.
Maya Angelou

Imagine home ten beautiful suites with high ceilings, large windows, generous closet space, private baths, and French doors leading to a private patio.

Picture a spacious living room adjoining a charming kitchen and dining room that invites gathering. Step through French doors and find yourself in a lovely walled garden full of flowers and water and light.

Think of a life of fullness with attention to detail and the best of care for the person you love.

We call it Academy Bella Vista. A reimaged assisted living residence offering exceptional memory care in a lovely and warm family setting.

MEMORY CARE

Academy Bella Vista offers options based on the level of care required. Every resident moving to Academy Bella Vista pays a Membership Fee in addition to the monthly dues and level of care.

AMENITIES AND SERVICES INCLUDED IN THE MONTHLY DUES

- Three meals and snacks each day, featuring natural and organic foods
- Weekly resident and family social hour
- Assistance with dressing, bathing, grooming and other activities of daily living (ADLs)
- Care coordination and oversight by Academy nurses
- Medication administration
- Weekly housekeeping and laundry
- Hydrotherapy tub
- Hearing aid clinic
- On-site activities that include daily exercise, outdoor walks, current events, performances by seasoned musicians, instruction in painting, arts and crafts, baking, flower arranging, movies, summer gardening, birthday and holiday celebrations, focused conversations
- Musical concerts and events at our nearby sister community, Academy University Hill
- Scenic outings and rides around Boulder
- Private chef on staff



Academy Homecare is a licensed Class A and Class B home health agency in the State of Colorado. Academy care partners are specially trained to provide personal care and companion services and are supervised by Academy licensed nurses.

Academy Homecare offers services in 60-minute increments. Services are individually customized to meet the resident's needs and include personal care, companionship, and chauffeur services and home assistance.

There is a one-time nurse assessment fee at start of service of \$150/hour. Homecare pricing varies according to length of shift.

30 minutes of service	\$22
60+ minutes of service (per hour)	\$42
Overnight Homecare (10 hour minimum)	\$40
Medication Management (per 30 mins)	\$55
Client errands using Care Partner's vehicle	
Mileage per mile	\$.655
Holiday upcharge to double time	

PERSONAL CARE SERVICES

Includes extra assistance with 1:1 care and activities, behavior management, fall prevention, overnight supervision, and other additional tasks

COMPANION SERVICES

Includes extra services such as light housekeeping, laundry, ironing, errands, pet care, transportation and companionship for activities and outings

INTERNAL MOVE \$2,500

ADDITIONAL SERVICES AVAILABLE

- Salon services
- Outings and lunches at local restaurants
- Dry Cleaning

WAITLIST DEPOSIT \$1,000

The deposit is applied to the membership fee. \$800 is refundable.

RESERVATION FEE \$1,000

The reservation fee is also applied to the membership fee.

MEMBERSHIP FEE \$15,000

MONTHLY DUES \$10,320 - \$10,750
+ LEVEL OF CARE

LEVEL OF CARE

Level of Care is determined by the care needs identified from the preliminary health assessment, current mobility, behavior support needs, activities of daily living (ADLs) assistance needs, and care coordination needs.

The level of care is reassessed quarterly and as care needs change.

CARE LEVEL ONE \$2,900

Minor assistance, cuing, and support needed. Resident is ambulatory, minor toileting assistance is needed, and resident needs minimal support with ADLs.

CARE LEVEL TWO \$5,200

Moderate assistance and greater support needed. Resident needs assistance with ambulation, toileting, cueing, challenging behaviors, and/or full support with ADLs.



LIFE *is in the*
DETAILS
Unknown